



# OUTDOOR/INDOOR INFRARED

Electric & Gas Heaters

**Dimplex**<sup>®</sup>



# DGR Series Outdoor Infrared Propane and Natural Gas Heaters

## DGR Series

Powerful, stylish heat for outdoor areas

### Infrared Heat

High-performance ceramic burner - 31,500 BTU.

### Versatile Application

Suitable for residential and commercial application.

### Durable

World-class wind protection up to 9.9 mph (16 km/hr).

### Innovative Design

Provides an easy setup with some assembly required.

### Commercial Grade

4 tile ceramic burner.

### Ease of Use

Electronic finger pull for easy ignition and turn-off.

### Safety

Protective grille and reflector included.

### Automatic Shut Off

Safety tilt switch ensures safe operation.

## DGR32WNG

This stylish and powerful heater is perfect for permanent installations in need of added comfort.



### DGR32WNG

31,500 BTU

25-1/2" x 16" x 12-1/2" (WxHxD)

65.0 cm x 40.6 cm x 31.8 cm

Wall-mount or ceiling-mount (optional ceiling bracket sold separately)

## Space-saving and powerful

Using a plumbed natural gas line, the DGR is always ready to provide up to 31,500 BTUs of heat in commercial or residential outdoor spaces.



TOP PROFILE

3.2' (1 m) 6.5' (2 m) 10' (3 m) 13' (4 m) 16.4' (5 m)

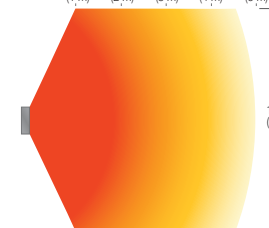

SIDE PROFILE

3.2' (1 m) 6.5' (2 m) 10' (3 m) 13' (4 m) 16.4' (5 m)

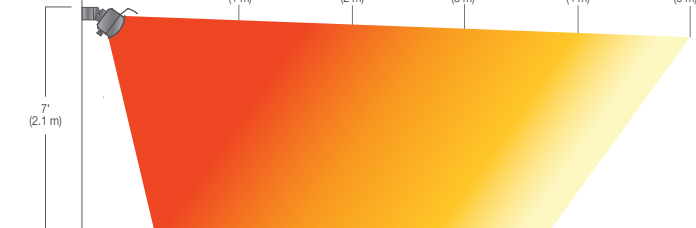



Enjoy portable heat where and when you need it.

## DGR32PLP

The stylish, portable DGR model is a sophisticated upgrade to any outdoor space.



Compatible with 20 lb (9 kg) propane tank (not included)

Hidden built-in wheels for easy portability and storage



### DGR32PLP

31,500 BTU

26-3/4" x 87-1/2" x 27" (WxHxD)  
68.0 cm x 222.0 cm x 69.0 cm

TOP PROFILE

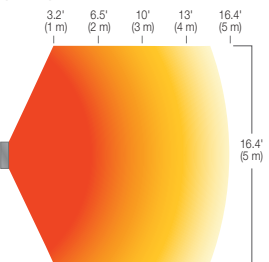

SIDE PROFILE

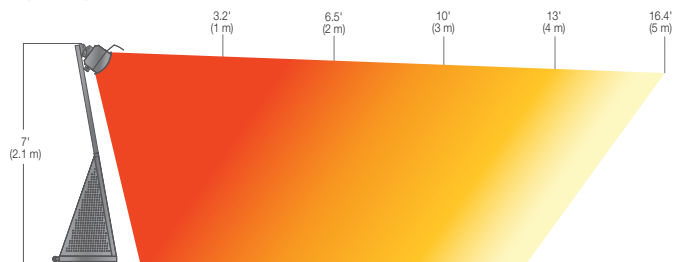

DGRSHIELD	Protective Heat Shield
DGRPOLE-WM	Ceiling-mount Bracket
TGHCOVER	Protective Cover



DGRSHIELD  
Compatible with  
DGR32WNG and  
DGR32PLP



DGRPOLE-WM  
Compatible with  
DGR32WNG



TGHCOVER  
Compatible with  
DGR32PLP

# DLW Series Outdoor / Indoor Radiant Electric Heaters

## DLW Series

Stylish, slimline electric radiant heaters - perfect for protected applications.

### Elegant Design

Slim profile is perfect for ceiling and wall-mount applications.

### Effective Radiant Heat

Warms like the sun, heating people and objects with zero visible light or glare.

### Weather-proof Construction

Safe, reliable design with an IP55 rating that provides protection against dust and water.

### Ease of Installation

Fully assembled, simply mount, and hardwire using the easy to access top-mounted junction box.

### Choice in Style

Offers flexibility in design with color options - choose either white or black to suit your style needs.

### Hardwire Installation

Designed for permanent installations on a dedicated circuit.

### Controls

Designed for hard-wired controls – switch or timer (not included).

### Top-mounted Junction Box



### DLW2400W24

Ceiling-mount installation shown  
240 Volts | 2,400 Watts  
53-1/2" x 5-5/8" x 6-1/2" (WxHxD)  
135.9 cm x 14.3 cm x 16.5 cm

## Radiant heat with style and performance!

The DLW series features a slim profile and blends with any décor. Available in a range of sizes and wattages, this long-wave radiant electric heater emits no visible light - great for low-light environments.







**DLW3200B24**

Wall-mount installation shown  
 240 Volts | 3,200 Watts  
 70" x 5-5/8" x 6-1/2" (WxHxD)  
 177.8 cm x 14.3 cm x 16.5 cm

Choice of color



Available in  
 White and Black

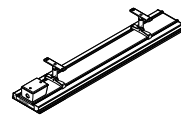

**DLW1500W12** (White)  
**DLW1500B12** (Black)

36" x 5-5/8" x 6-1/2" (WxHxD)  
 91.4 cm x 14.3 cm x 16.5 cm  
 120 Volts | 1,500 Watts

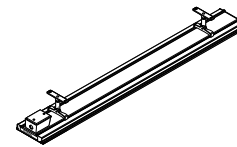

**DLW2400W24** (White)  
**DLW2400B24** (Black)

53-1/2" x 5-5/8" x 6-1/2" (WxHxD)  
 135.9 cm x 14.3 cm x 16.5 cm  
 240 Volts | 2,400 Watts

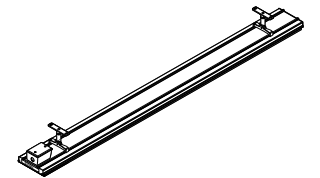

**DLW3200W24** (White)  
**DLW3200B24** (Black)

70" x 5-5/8" x 6-1/2" (WxHxD)  
 177.8 cm x 14.3 cm x 16.5 cm  
 240 Volts | 3,200 Watts



# DLW Series Outdoor / Indoor Radiant Electric Heaters

## DLW1500W12

Ceiling-mount installation shown  
 120 Volts | 1,500 Watts  
 36" x 5-5/8" x 6-1/2" (WxHxD)  
 91.4 cm x 14.3 cm x 16.5 cm

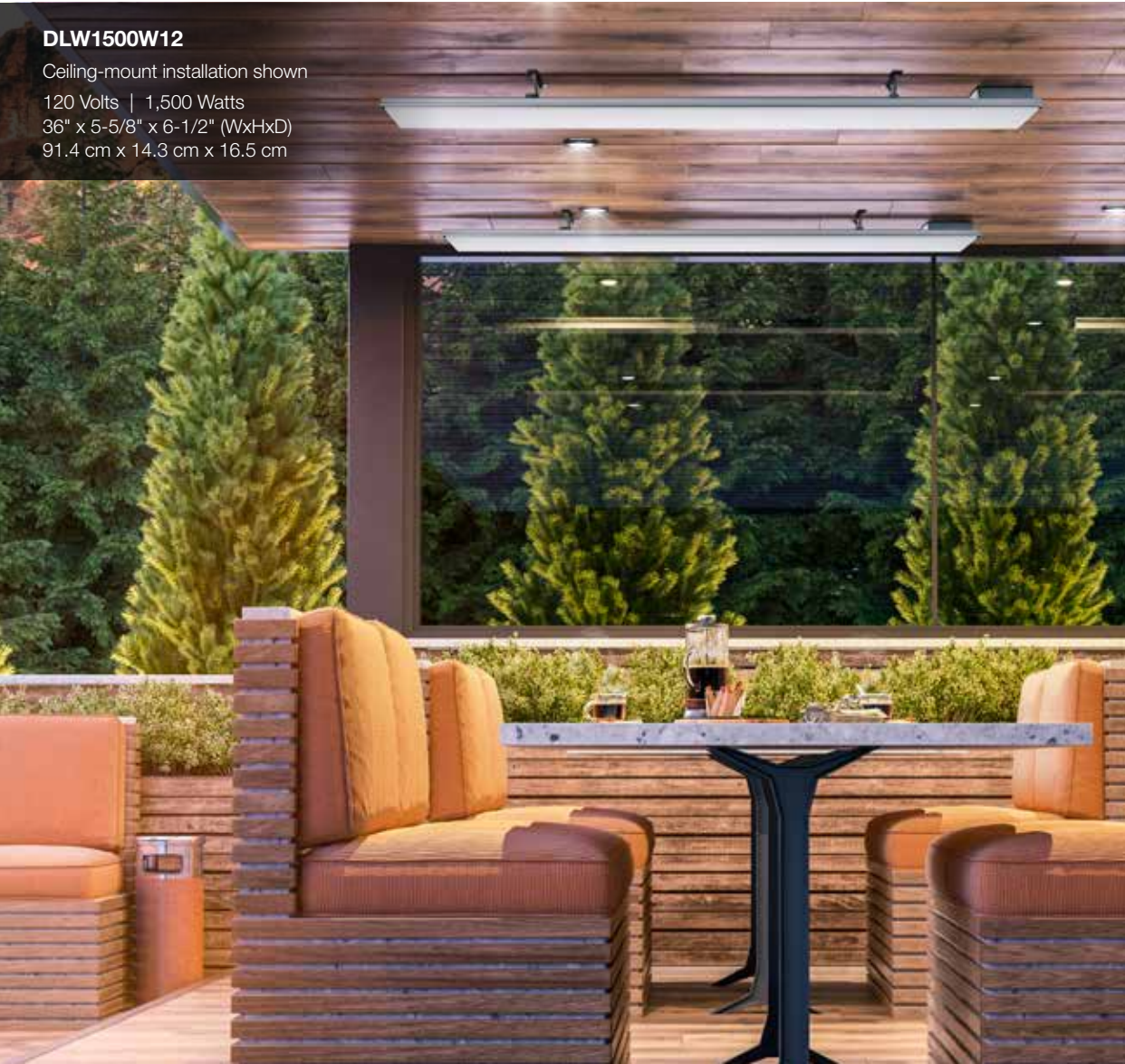

## Optional Ceiling-mount Extension Poles

Use to lower the heaters to the optimal height of 8' (2.4 m) to ensure maximum comfort and performance.

Available in four different lengths:

DLWAC12SIL	12" Ceiling-mount Extension Pole
DLWAC24SIL	24" Ceiling-mount Extension Pole
DLWAC36SIL	36" Ceiling-mount Extension Pole
DLWAC48SIL	48" Ceiling-mount Extension Pole



## DLW2400W24

Shown with 12" Ceiling-mount extension pole DLWAC24SIL



Outdoor enclosed area

Indoor spot heating area

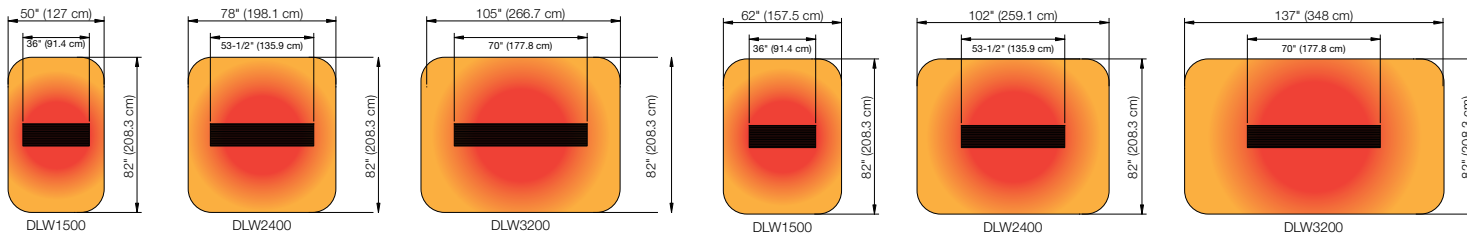



# DSH Series Outdoor / Indoor Infrared Electric Heater

## DSH20W

240 Volts | 2,000 Watts  
23-1/2" x 6" x 12-7/8" (WxHxD)  
59.6 cm x 15.4 cm x 32.6 cm

## DSH Series Versatile installation

The ultra-versatile DSH heater comes ready for wall-mounting, with the option to add a ceiling-mount or floor stand. For additional heat, double-up the heater in a ceiling or floor stand installation. Perfect for commercial installations.



Powerful  
infrared  
heating, when  
and where  
you need it.



## DSH Series

Powerful infrared heating,  
when and where you need it

### Instant Heat

Get heat on demand with a gold-tube quartz element that provides full power in under 6 seconds.

### Timer

Set timer to automatically shut off the heater after a preset time, up to 3 hrs.

### Weather-proof Construction

Suitable for all climates, with an IP65 rating for outdoor or indoor use.

### Corrosion Resistant

Built to last with anodized aluminum casing that provides a long life.

### Durable

Meant to keep you warm for years with up to 5,000 hours of running life.

### Ease of Installation

Each heater comes with the element pre-installed, which eases the installation and reduces the risk of damaged, broken or misplaced elements upon delivery.

### Installation Options

Includes pivoting mounting bracket for the wall, optional ceiling mount or floor stand sold separately.

### Hardwire Connection

Designed for permanent installations on a direct wired dedicated circuit.

### Adjustable Angle

For optimum heat, direct the unit toward the area you want to warm up.

### Remote Control (included)

Stay in control, multiple heaters can be operated with a single remote.

### Automatic Standby

Unit has safety mechanism that automatically places the heater in Standby mode after 8 hours of continuous operation.



**DSH20W**

Permanent Location Floor Stand  
DSHSTAND (shown with 2 heaters)



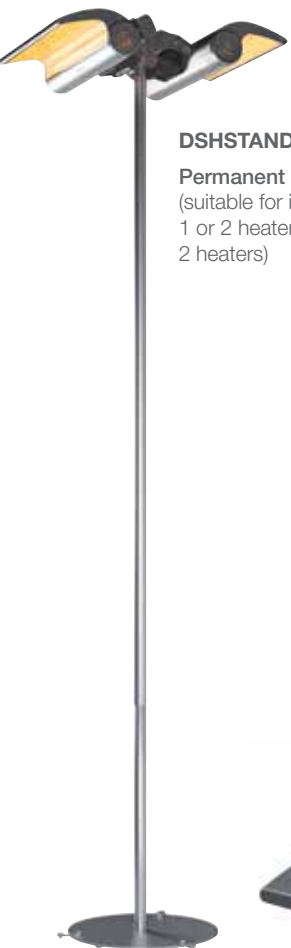

**DSHSTAND**  
Permanent Location Floor Stand  
(suitable for installation with  
1 or 2 heaters, shown with  
2 heaters)



**DSHCMB**  
Ceiling-mount Bracket  
(suitable for installation with 1 or 2  
heaters, shown with 1 heater)

Wall-mount bracket included



Outdoor heating area

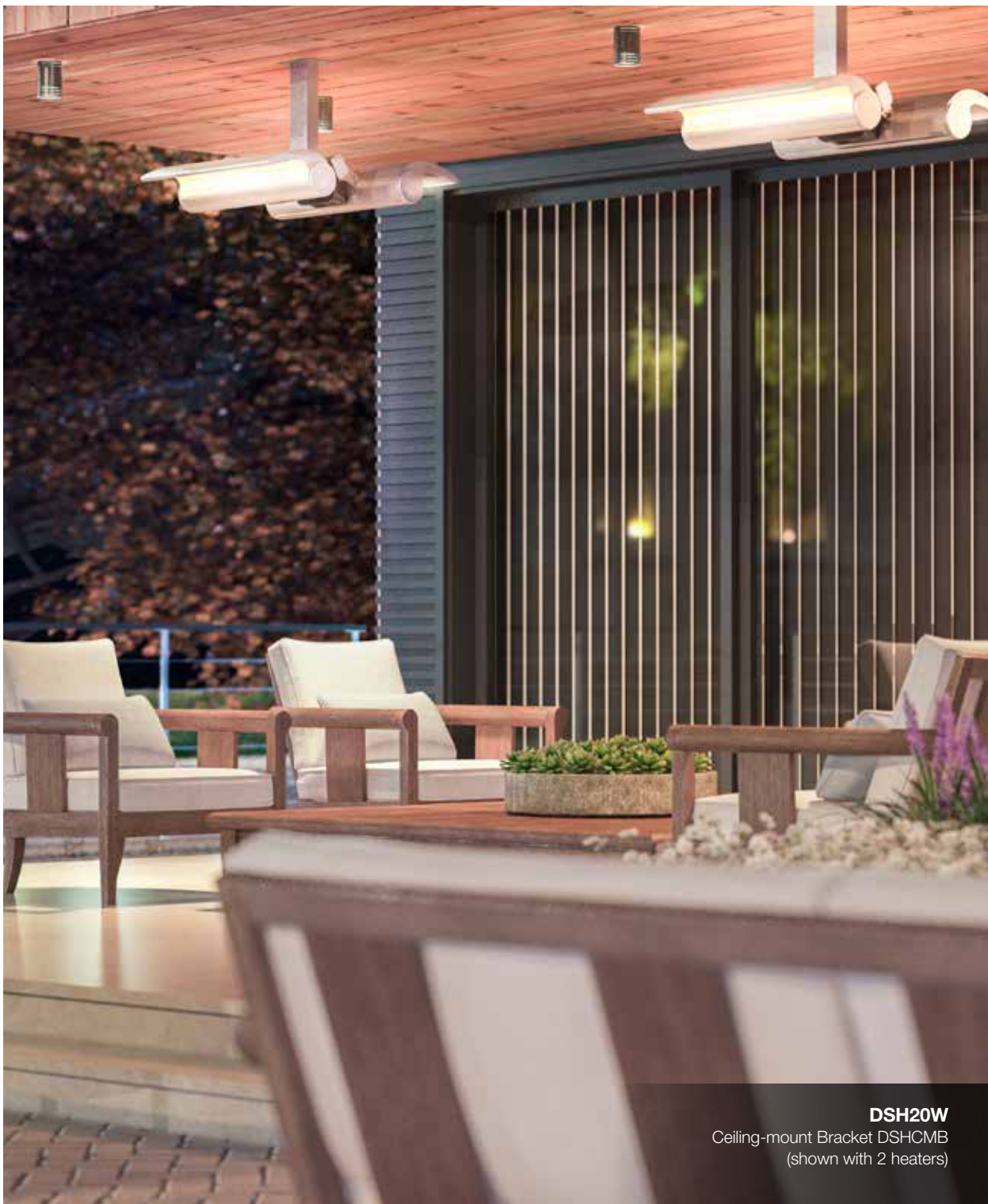
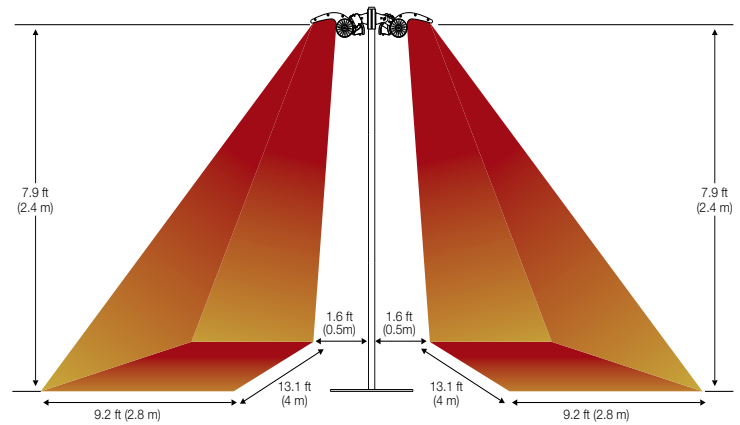

**DSH20W**  
Ceiling-mount Bracket DSHCMB  
(shown with 2 heaters)



## DIR Series Infrared heat with style and performance

### Schott Nextrema® Glass

Schott Nextrema® glass combines high-temperature, thermal shock and chemical resistance, excellent infrared transmission, non-porous surface and attractive design.

### Instant Heat

Ruby halogen bulb provides full power in under 6 seconds.

### Weather-proof Construction

IP65 rated for outdoor or indoor use.

### Corrosion Resistant

Anodized aluminum casing provides long life.

### Durable

Up to 5,000 hours of running life.

### Installation Option

Includes pivoting mounting bracket.

### Hardwire Connection

Designed for permanent installations on a dedicated circuit.

### Adjustable Angle

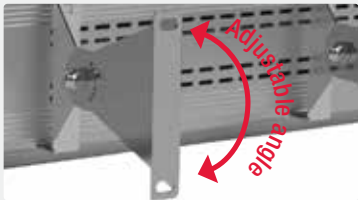

### Timer

Set timer to automatically shut off the heater after a preset time.

### Automatic Standby

Unit has safety mechanism that automatically places the heater in Standby mode after 8 hours of continuous operation.

### Ease of Installation

Each heater comes with the element pre-installed, which eases in installation and reduces the risk of damaged, broken or misplaced elements upon delivery.

### Remote control included



### DIR15A10GR

Ceiling and wall-mount option  
120 Volts | 1,500 Watts

### DIR22A10GR

Wall-mount only  
240 Volts | 2,200 Watts

35-1/2" x 6-3/4" x 5" (WxHxD)  
90.2 cm x 17.0 cm x 12.8 cm

## Heat in Seconds

The DIR is a sleek, safe infrared heater with extraordinary performance and available in a range of sizes and wattages. Great for commercial and residential spaces.





# DIR30A10GR

High-output Infrared Heater

## Style and Performance

Full heating power available in under 6 seconds, you can go from cold to comfortable with a quick touch of the remote control.



### DIR30A10GR

Wall-mount only  
240 Volts | 3,000 Watts

50-5/8" x 6-3/4" x 5" (WxHxD)  
128.6 cm x 17.0 cm x 12.8 cm

Exclusive features:

#### More Power

Get twice the length of the original DIR15 or DIR22 models, providing twice as much infrared heat – it's like getting two units in one.

#### Installation Option

Includes pivoting mounting bracket and hardware for a wall-mount installation only.



Indoor heating area wall-mounted

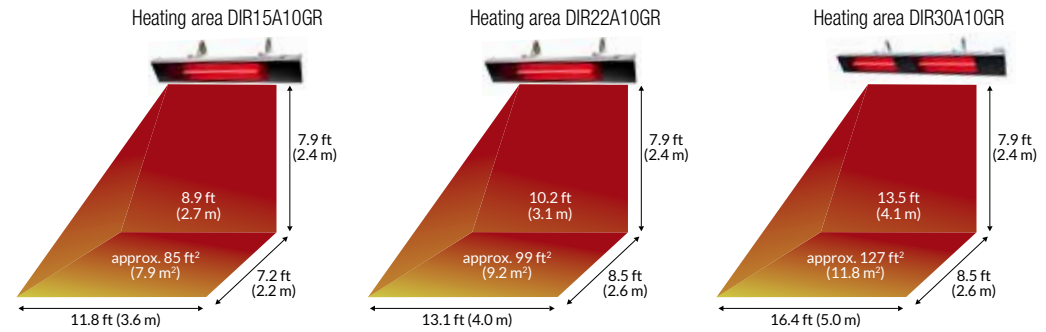

Outdoor heating area wall-mounted

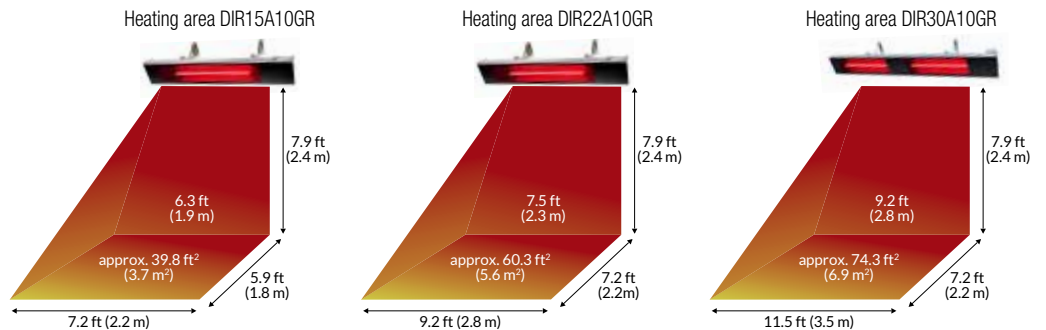



## DIR Plug-in Series

### Outdoor/Indoor Wall-mount Infrared Heater.

#### Schott Nextrema® Glass

Schott Nextrema® glass combines high-temperature, thermal shock and chemical resistance, excellent infrared transmission, non-porous surface and attractive design.

#### Instant Heat

Ruby halogen bulb provides full power in under 6 seconds.

#### Innovative Design

Ensures a safe, easy and space-saving installation. Includes pivoting mounting bracket.

#### Maximum Comfort

3 power settings: low (600W), medium (1050W), high (1500W).

#### Timer

Set timer to automatically shut off the heater after a preset time, up to 13 hrs.

#### On-screen Display

Shows power setting and timer function at a glance.

#### Just Plug It In

7.7 ft. (2.3 m) cord with grounded plug, standard 120V outlet.



**DIRP15A10GR**

Wall-mount only  
120 Volts | 1,500 Watts

35-1/2" x 10-7/8" x 11-3/4" (WxHxD)  
90.2 cm x 27.6 cm x 29.9 cm

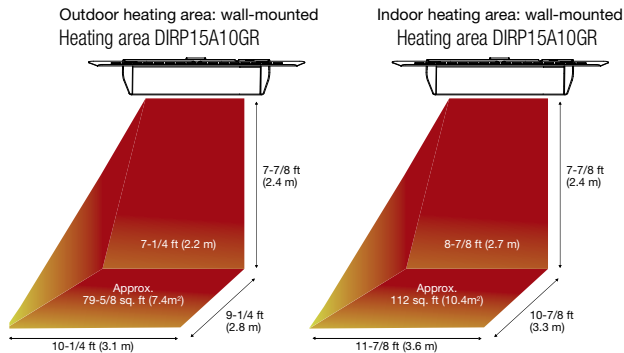

## Powerful heat combined with convenience

Infrared heat at its finest; keep family, friends, guests, or patrons comfortable with sun-like warmth in a matter of seconds. Mount, plug-in, and heat – installation made easy.



For more information and product specifications, please visit [dimplex.com](http://dimplex.com)



Specifications, finishes and dimensions are subject to change and should be taken as a guide only. This product may be covered by one or more U.S. patents or pending patent applications. See [www.dimplex.com/en/patents](http://www.dimplex.com/en/patents) for details. © 2021 Glen Dimplex Americas



**Dimplex®**

A BRAND OF GLEN DIMPLEX AMERICAS

Printed in Canada LI-1041-R03-101221